

LEGEND:

PIPE GOING DOWN

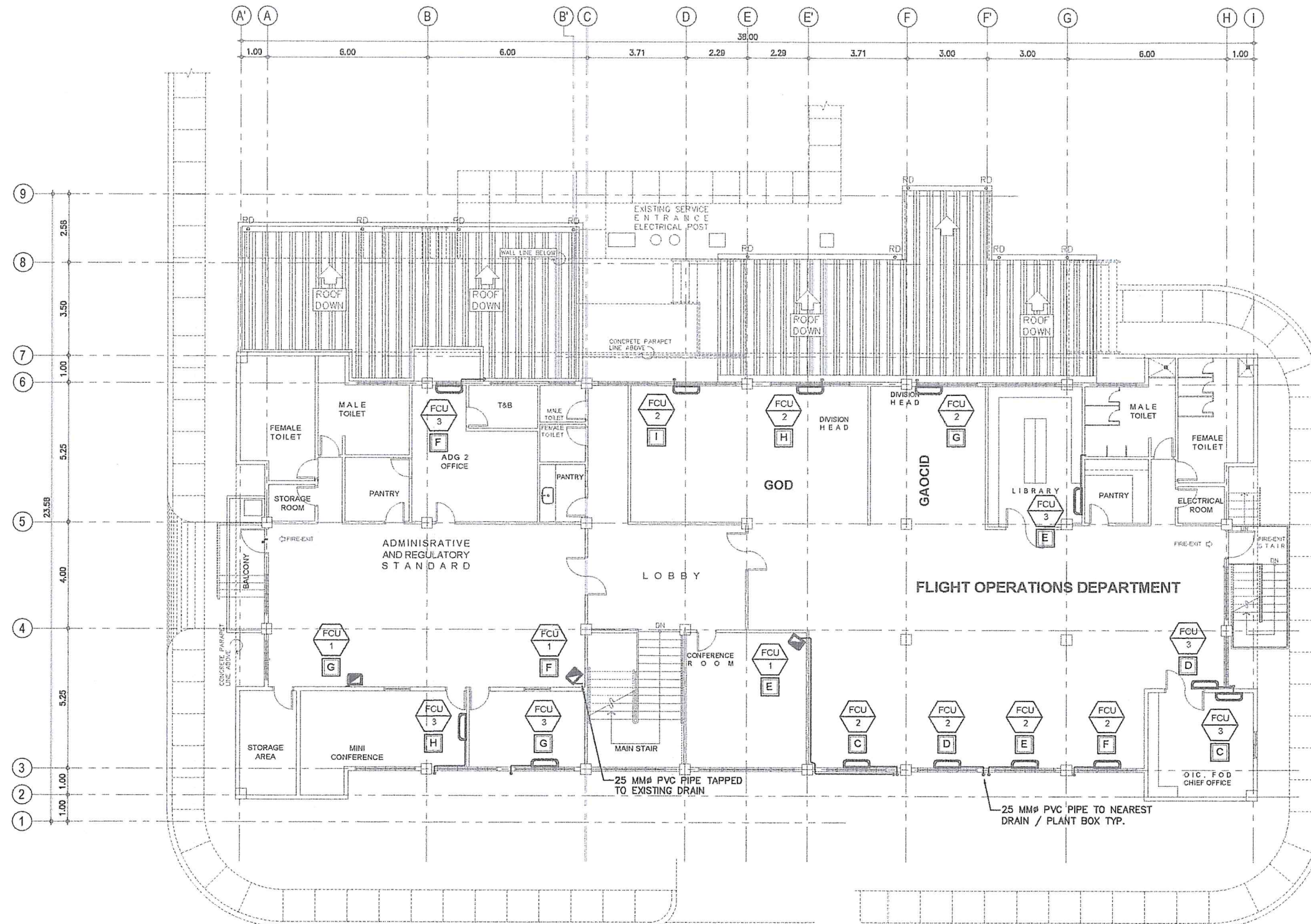

1 SECOND FLOOR ACU CONDENSATE DRAIN PIPE LAYOUT
SCALE: 1:100 MTS.



CIVIL AVIATION AUTHORITY OF THE PHILIPPINES
HEAD OFFICE - PASAY CITY

THIS DRAWING IS EXCLUSIVE PROPERTY OF THE CIVIL AVIATION AUTHORITY OF THE PHILIPPINES AND MUST NOT BE REPRODUCED, EXHIBITED, LOANED NOR COPIED IN PART OR IN WHOLE WITHOUT PROPER PERMISSION AND/OR WRITTEN CONSENT FROM THE DIRECTOR GENERAL CAAP.

AERODROME DEVELOPMENT AND MANAGEMENT SERVICE

INFRASTRUCTURE DEVELOPMENT & DESIGN DIVISION

DESIGN STAFF:	INITIAL / DATE
DESIGNED BY: IODD	
DRAWN BY: JCMC	
CHECKED BY: RUJR	

REVIEWED BY:

RAUL R. CRUCENA
Division Chief III, IODD - ADMS

SUBMITTED BY:

ARNEL F. BORLADO
Department Manager III, AED-ADMS

APPROVED:

LT COL VALENTINO A. DIONELA PAF (RET)
ADG II, ADMS

NOTES/REVISIONS:

PROJECT:
SUPPLY AND INSTALLATION OF TWENTY FOUR (24) SETS INVERTER AIR-CONDITIONING UNITS AT FSIS BUILDING

LOCATION:
CAAP HEAD OFFICE
NAIA ROAD, PASAY CITY

SHEET CONTENTS:

SECOND FLOOR ACU CONDENSATE DRAIN PIPE LAYOUT

DRAWING SCALE:	SHEET NO:
AS SHOWN	M - 4
	4

GENERAL NOTES:

1. IT IS NOT INTENDED THAT THE DRAWINGS SHALL SHOW EVERY PIPE FITTINGS, DUCT FITTINGS, VALVES, DAMPERS, HANGERS/SUPPORTS, ETC.. ALL SUCH ITEM WHETHER SPECIFICALLY MENTIONED OR NOT, OR INDICATED ON THE DRAWINGS SHALL BE FURNISHED AND INSTALLED IF NECESSARY TO COMPLETE THE SYSTEM TO THE SATISFACTION OF THE ENGINEER AND THE OWNER.
2. CONTRACTOR SHALL BE RESPONSIBLE IN VERIFYING AND COORDINATING, THE FOLLOWING IN ACCORDANCE WITH MANUFACTURER'S DATA AND RECOMMENDATIONS.

A. FLOOR, ROOF AND WALL OPENINGS

B. EQUIPMENT PADS/PEDESTALS

C. CONDENSATE DRAIN LINES
3. ALL PIPE SIZES ARE IN MILLIMETER (mm) UNLESS OTHERWISE INDICATED.
4. ALL STRUCTURAL AND ARCHITECTURAL FINISHES DAMAGED DURING THE COURSE OF WORK SHALL BE RESTORED TO IT'S ORIGINAL CONDITION OR AS APPROVED BY OWNER.
5. PROVIDE SERVICE ACCESS & CLEARANCE TO CHANGE AIR FILTER ELEMENT FOR AC EQUIPMENT AS RECOMMENDED BY MANUFACTURER.
6. ALL INSULATED MECHANICAL PIPES THAT ARE EXPOSED SHALL BE CLADDED WITH ALUMINUM SHEET. CLADDING SHALL BE MACHINE/SHOP FABRICATED.
7. CONTRACTOR/VENDOR SHOULD BE FAMILIAR WITH THE ACTUAL SITE CONDITION AND INSTALLATION TO VERIFY IF THE WORK IS IN CONFORMANCE TO MANUFACTURER RECOMMENDATION AND SHOULD RECTIFY IF SUCH CONDITION EXIST.
8. THE CONTRACTOR SHALL COORDINATE W/ THE STRUCTURAL, SANITARY, ARCHITECTURAL AND ELECTRICAL REGARDING THE ROUGHING-INS OF FUTURE AIR CONDITIONING UNITS. ALL EMBEDDED ITEMS SHALL BE INSTALLED IN PLACE UNDER THIS CONTRACT.
9. FINAL EQPT. TAG NUMBERING SHALL BE MADE BY THE OWNER'S ENGINEERING DEPARTMENT FOR CASE OF IDENTIFICATION OF INDIVIDUAL UNIT.
10. INSTALLATION OF ALL WORKS SHALL BE DONE IN A NEAT AND WORKMANLIKE MANNER, IMPROPERLY SET WORK OR FINISH AS DETERMINED BY THE ARCHITECT SHALL BE REMOVED AND REPLACED AT NO EXTRA COST.
11. ALL MATERIALS TO BE USED SHALL BE BRAND NEW AND CLEAN.
12. DEVIATION AND REVISIONS FROM PLAN SHALL BE REFERRED TO THE ARCHITECT/ENGINEER FOR REVIEW AND APPROVAL.
13. ALL NECESSARY GOVERNMENT PERMIT SHALL BE SECURED AND PAID FOR THE CONTRACTOR.
14. ALL MECHANICAL WORKS SHALL BE IN ACCORDANCE WITH THE LATEST MECHANICAL ENGINEER'S CODE ASVE, ASHRAE AND SMACNA STANDARD.
15. ALL A/C AND VENTILATING EQUIPMENT CONTROL PANEL SWITCH AND CIRCUIT BREAKERS ARE PROVIDED BY THE MECHANICAL CONTRACTOR.
16. THE MECHANICAL CONTRACTOR SHALL CONDUCT TESTING, BALANCING AND COMMISSIONING OF ALL A/C AND VENTILATING EQUIPMENT.

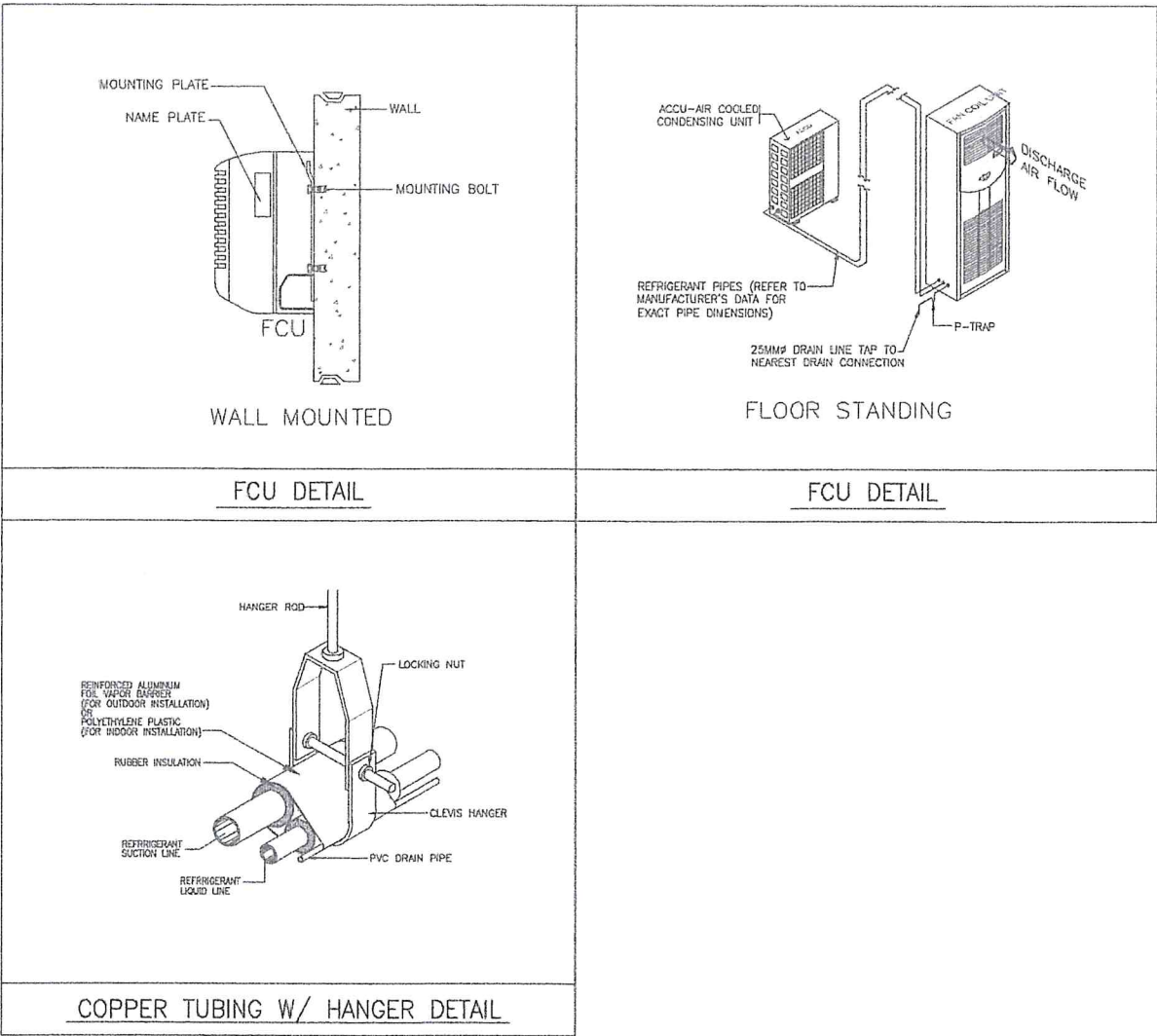

FAN COIL UNIT (INDOOR UNIT)

MARK	QTY.	LOCATION / AREA SERVED	COOLING LOAD/UNIT HP (TR)	DRAIN LINE mm (IN)	REFRIGERANT		ELECTRICAL DATA			NET WEIGHT KG	REMARKS	
					TYPE	PIPE CONNECTION		V	PH			HZ
						GAS LINE mm (IN)	LIQUID LINE mm (IN)					
<div>FCU 1</div>	7	GROUND FLOOR LOBBY, AIRWORTHINESS DEPARTMENT, 2ND FLR CONF. ROOM & ADMIN	4.0 (3.0)	25 (1)	R-410a /R-32	15.88 (5/8)	9.52 (3/8)	220-230	1	60	54	INVERTER FLOOR STANDING TYPE INDOOR FREE BLOW FAN COIL UNIT COMPLETE WITH REMOTE WIRELESS, TEMPERATURE CONTROLLER, FAN SPEED SWITCH, DRAIN PUMP, EQUIPMENT SUPPORT AND STANDARD ACCESSORIES.
<div>FCU 2</div>	9	GACID, CATCID & FOD STAFF AREA	3.0	25 (1)	R-32	15.88 (5/8)	6.35 (1/4)	220-230	1	60	16.5	INVERTER WALL MOUNTED TYPE INDOOR FREE BLOW FAN COIL UNIT COMPLETE WITH REMOTE WIRELESS, TEMPERATURE CONTROLLER, FAN SPEED SWITCH, EQUIPMENT SUPPORT AND STANDARD ACCESSORIES.
<div>FCU 3</div>	8	AIRWORTHINESS CONF. & PROCESSING ROOM, FOD STAFF, FOD CHIEF OFFICE & LIBRARY, ARS OFFICE & MINI CONF.	2.0	25 (1)	R-32	12.70 (1/2)	6.35 (1/4)	220-230	1	60	11	INVERTER WALL MOUNTED TYPE INDOOR FREE BLOW FAN COIL UNIT COMPLETE WITH REMOTE WIRELESS, TEMPERATURE CONTROLLER, FAN SPEED SWITCH, EQUIPMENT SUPPORT AND STANDARD ACCESSORIES.

AIR COOLED CONDENSING UNIT (OUTDOOR UNIT)

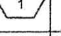
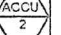
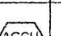
MARK	QTY.	CAPACITY HP (TR)	EQUIPMENT SERVED	REFRIGERANT		ELECTRICAL DATA			NET WEIGHT KG	REMARKS	
				TYPE	PIPE CONNECTION		V	PH			HZ
					GAS LINE mm (IN)	LIQUID LINE mm (IN)					
	7	4.0 (3.0)	FCU-1	R-410a /R-32	15.88 (5/8)	9.52 (3/8)	220-230	1	60	55	INVERTER FLOOR MOUNTED AIR COOLED CONDENSER UNIT COMPLETE WITH CONDENSER FAN, HERMETIC COMPRESSOR, ELECTRICAL CONNECTION AND EQUIPMENT PAD. THE UNIT SHALL BE THE SAME MANUFACTURER OF FCU.
	9	3.0	FCU-3	R-32	15.88 (5/8)	6.35 (1/4)	220-230	1	60	43	INVERTER FLOOR MOUNTED AIR COOLED CONDENSER UNIT COMPLETE WITH CONDENSER FAN, HERMETIC COMPRESSOR, ELECTRICAL CONNECTION AND EQUIPMENT PAD. THE UNIT SHALL BE THE SAME MANUFACTURER OF FCU.
	8	2.0	FCU-4	R-32	12.70 (1/2)	6.35 (1/4)	220-230	1	60	25	INVERTER FLOOR MOUNTED AIR COOLED CONDENSER UNIT COMPLETE WITH CONDENSER FAN, HERMETIC COMPRESSOR, ELECTRICAL CONNECTION AND EQUIPMENT PAD. THE UNIT SHALL BE THE SAME MANUFACTURER OF FCU.



THIS DRAWINGS IS EXCLUSIVE PROPERTIES OF CIVIL AVIATION AUTHORITY OF THE PHILIPPINES AND MUST NOT BE REPRODUCED, EXHIBITED, LOANED NOR COPIED IN PART OR IN WHOLE WITHOUT PROPER PERMISSION AND/OR WRITTEN CONSENT FROM THE DIRECTOR GENERAL CAAP.

AERODROME DEVELOPMENT AND MANAGEMENT SERVICE

INFRASTRUCTURE DEVELOPMENT & DESIGN DIVISION

DESIGN STAFF:	INITIAL / DATE
DESIGNED BY:	IDDD
DRAWN BY:	JCMC
CHECKED BY:	RUAJR

REVIEWED BY:

RAUL R. CRUCENA
Division Chief III, IDDD-ADMS

SUBMITTED BY:

ARNEL F. BORJADO
Department Manager III, AED-ADMS

APPROVED:

LT COL. VALENTINO A. DIONELA PAF (RET)
ADG II, ADMS

NOTES/REVISIONS:

PROJECT:
SUPPLY AND INSTALLATION OF TWENTY FOUR (24) SETS INVERTER AIR-CONDITIONING UNITS AT FSIS BUILDING

LOCATION:
CAAP HEAD OFFICE
NAIA ROAD, PASAY CITY

SHEET CONTENTS:
GENERAL NOTES
MISCELLANEOUS DETAILS
EQUIPMENT SCHEDULE

DRAWING SCALE:	SHEET NO.
AS SHOWN	M - 5
	5