

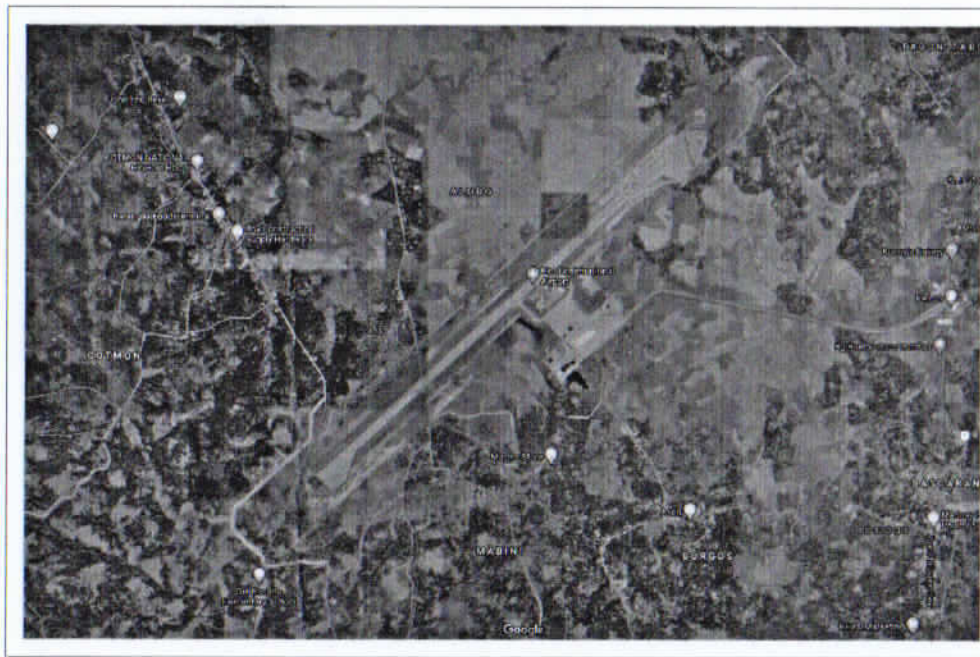

MAP OF THE PHILIPPINES

SCALE:

NTS.



VICINITY MAP

SCALE:

NTS.

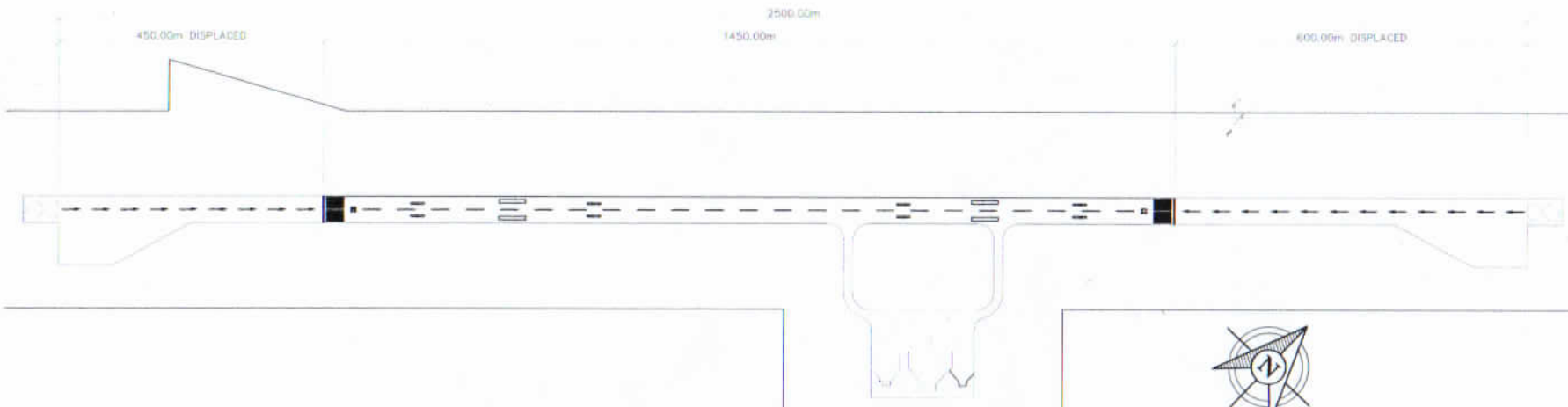

RUNWAY LAYOUT PLAN

SCALE:

NTS.



REPUBLIC OF THE PHILIPPINES
CIVIL AVIATION AUTHORITY OF THE PHILIPPINES

THIS DRAWING IS EXCLUSIVE PROPERTIES OF CIVIL AVIATION AUTHORITY OF THE PHILIPPINES AND MUST NOT BE REPRODUCED, EXHIBITED, LOANED NOR COPIED IN PART OR IN WHOLE WITHOUT PROPER PERMISSION AND/OR WRITTEN CONSENT FROM THE DIRECTOR GENERAL CAAP.

AERODROME DEVELOPMENT AND MANAGEMENT SERVICE
AREA-V, LEGAZPI AIRPORT

ENGINEERING & PLANNING UNIT

PREPARED BY:

[Signature]
LIMUEL MARI T. MALLORCA
AIRPORT TECHNICAL ASSISTANT

CHECKED BY:

[Signature]
MARC ANTHONY D. SABALDICA
AERODROME ENGINEER

APPROVAL RECOMMENDED BY:

[Signature]
ANDREW N. APPELLANO
EPM IN-CHARGE

APPROVED BY:

[Signature]
CYNTHIA M. TUMANUT
AREA/AIRPORT MANAGER,
CAAP AREA V

PROJECT:

**REPAIR & REPAINTING OF
RUNWAY, TAXIWAY AND
APRON MARKING
AND MARKERS**

LOCATION:

**BICOL INTERNATIONAL AIRPORT
DARAGA, ALBAY**

CONTENT:

• LAYOUT PLAN

SHEET NO.

01
06



REPUBLIC OF THE PHILIPPINES
CIVIL AVIATION AUTHORITY OF THE PHILIPPINES

THIS DRAWING IS EXCLUSIVE PROPERTIES OF CIVIL AVIATION AUTHORITY OF THE PHILIPPINES AND MUST NOT BE REPRODUCED, EXHIBITED, LOANED NOR COPIED IN PART OR IN WHOLE WITHOUT PROPER PERMISSION AND/OR WRITTEN CONSENT FROM THE DIRECTOR GENERAL CAAP.

AERODROME DEVELOPMENT AND MANAGEMENT SERVICE
AREA-V, LEGAZPI AIRPORT

ENGINEERING & PLANNING UNIT

PREPARED BY:

[Signature]
LIMUEL MARI T. MAZORCA
AIRPORT TECHNICAL ASSISTANT

CHECKED BY:

[Signature]
MARC ANTHONY D. SABALDICA
AERODROME ENGINEER

APPROVAL RECOMMENDED BY:

[Signature]
ANDREW N. ARELLANO
EPD IN CHARGE

APPROVED BY:

[Signature]
CYNTHIA M. TUMAMUT
AREA/AIRPORT MANAGER,
CAAP AREA V

PROJECT:

REPAIR & REPAINTING OF
RUNWAY, TAXIWAY AND
APRON MARKING
AND MARKERS

LOCATION:

BICOL INTERNATIONAL AIRPORT
DARAGA, ALBAY

CONTENT:

• BLOW UP RWY DETAIL

SHEET NO:

02
06

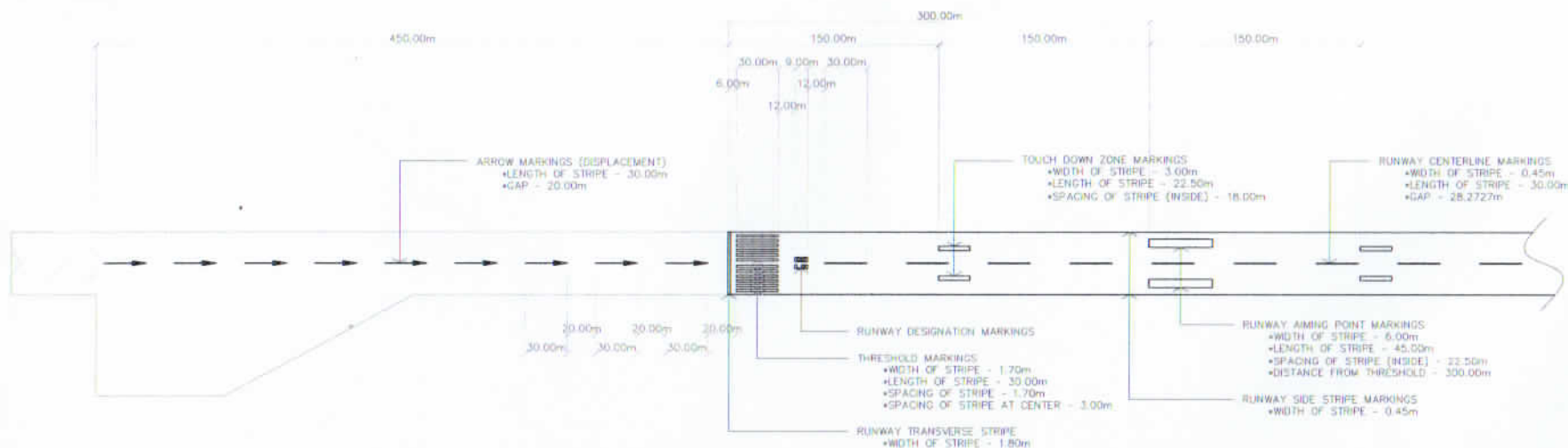

BLOW UP (RWY 05)

SCALE: NTS.

NOTE:
REMOVAL/STRIPPING OF EXISTING
MARKINGS FOR SITE PREPARATION

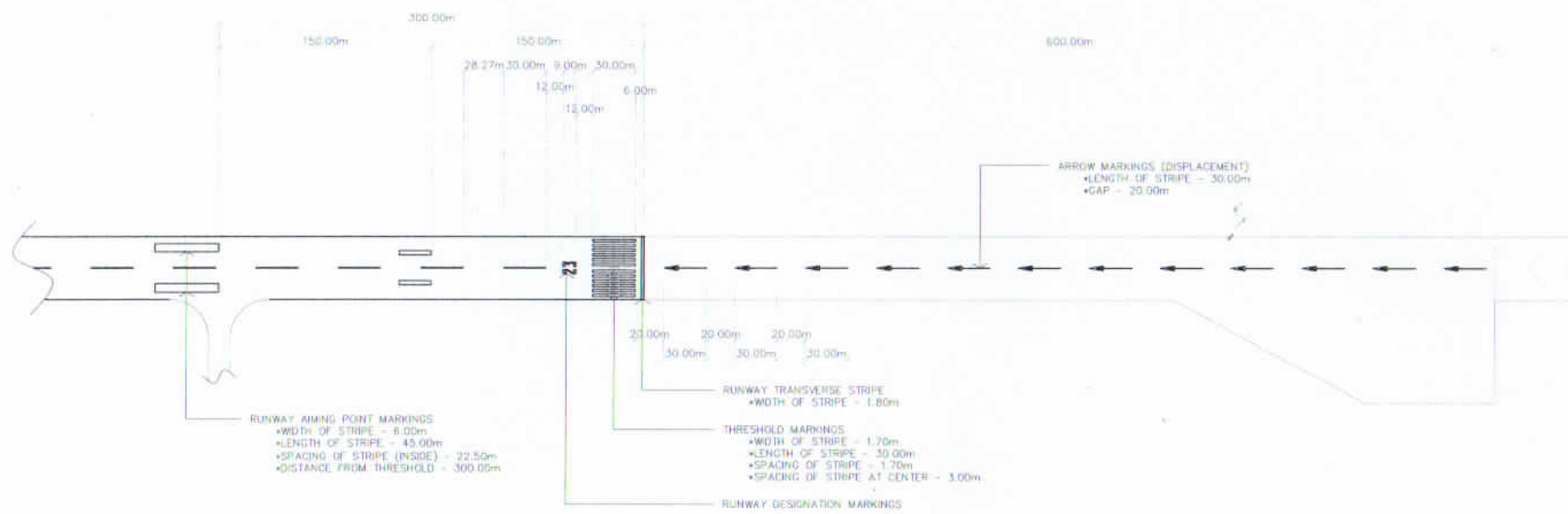

BLOW UP (RWY 23)

SCALE: NTS.



REPUBLIC OF THE PHILIPPINES
CIVIL AVIATION AUTHORITY OF THE PHILIPPINES

THIS DRAWING IS EXCLUSIVE PROPERTIES OF
CIVIL AVIATION AUTHORITY OF THE PHILIPPINES
AND MUST NOT BE REPRODUCED,
EXHIBITED, LOANED NOR COPIED IN PART OR IN
WHOLE WITHOUT PROPER PERMISSION AND/OR
WRITTEN CONSENT FROM THE DIRECTOR GENERAL
CAAP.

AERODROME DEVELOPMENT AND
MANAGEMENT SERVICE
AREA-V, LEGAZPI AIRPORT

ENGINEERING & PLANNING UNIT

PREPARED BY:

Limuel Mari F. Mallorca
LIMUEL MARI F. MALLORCA
AIRPORT TECHNICAL ASSISTANT

CHECKED BY:

Marc Anthony D. Sabaldica
MARC ANTHONY D. SABALDICA
AERODROME ENGINEER

APPROVAL RECOMMENDED BY:

Andrew N. Arrellano
ANDREW N. ARRELLANO
EPO IN-CHARGE

APPROVED BY:

Cynthia M. Tumanut
CYNTHIA M. TUMANUT
AREA/AIRPORT MANAGER,
CAAP AREA V

PROJECT:

**REPAIR & REPAINTING OF
RUNWAY, TAXIWAY AND
APRON MARKING
AND MARKERS**

LOCATION:

**BICOL INTERNATIONAL AIRPORT
DARAGA, ALBAY**

CONTENT:

• APRON MARKINGS

SHEET NO:

03
06

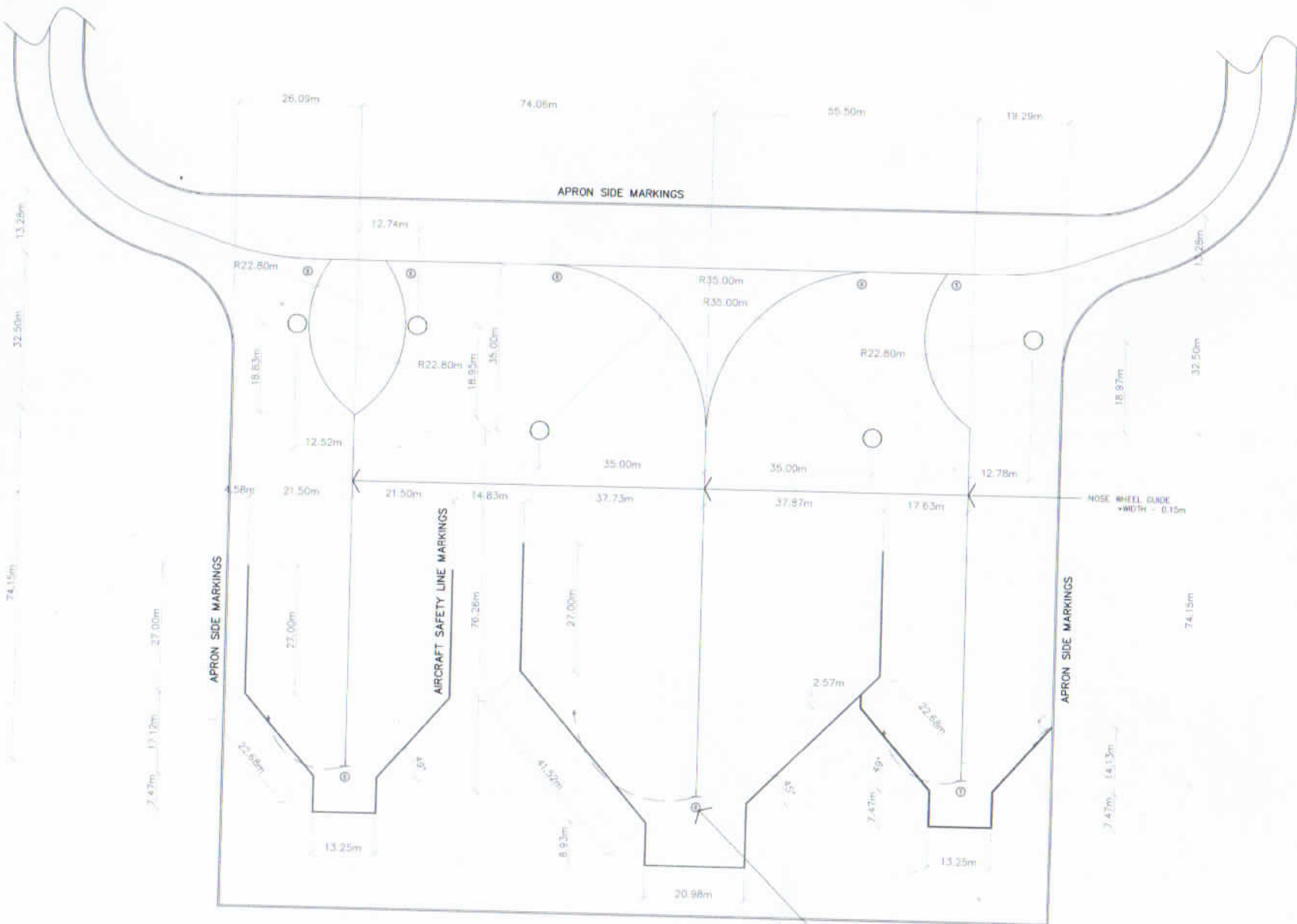

PARKING DESIGNATION NUMBER
(SEE DETAIL)



APRON MARKINGS

SCALE:

NTS.

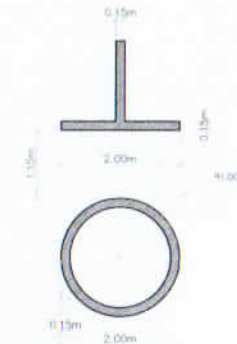
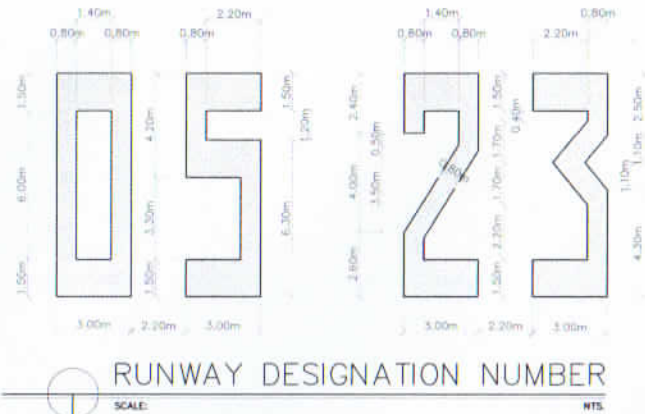
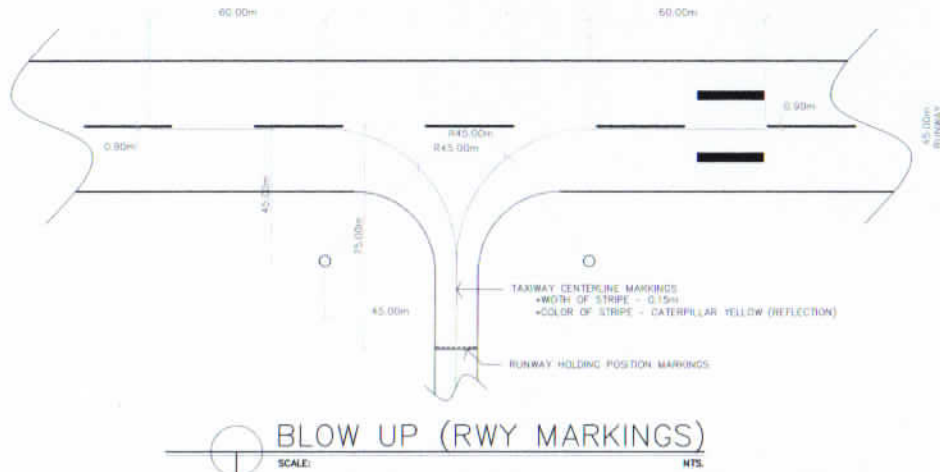
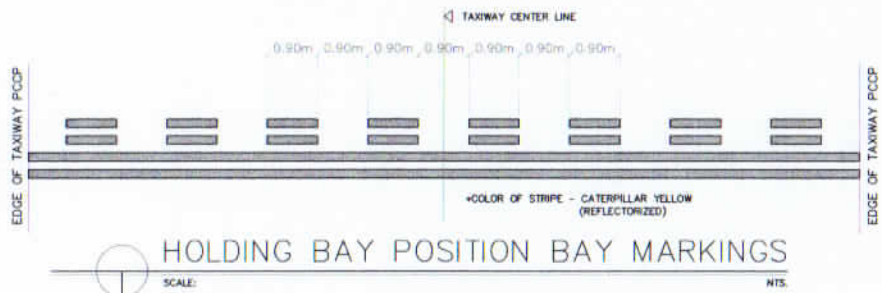
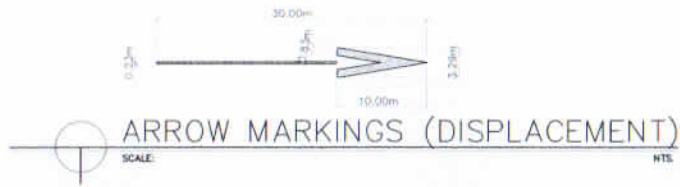

REPUBLIC OF THE PHILIPPINES
CIVIL AVIATION AUTHORITY OF THE PHILIPPINES

THIS DRAWING IS EXCLUSIVE PROPERTIES OF CIVIL AVIATION AUTHORITY OF THE PHILIPPINES AND MUST NOT BE REPRODUCED, EXHIBITED, LOANED NOR COPIED IN PART OR IN WHOLE, WITHOUT PROPER PERMISSION AND/OR WRITTEN CONSENT FROM THE DIRECTOR GENERAL CAA/P.

AERODROME DEVELOPMENT AND MANAGEMENT SERVICE
AREA-V, LEGAZPI AIRPORT

ENGINEERING & PLANNING UNIT

PREPARED BY:

Limuel Mari T. Mallorca
LIMUEL MARI T. MALLORCA
AIRPORT TECHNICAL ASSISTANT

CHECKED BY:

Marc Anthony D. Sabaldica
MARC ANTHONY D. SABALDICA
AERODROME ENGINEER

APPROVAL RECOMMENDED BY:

Andrew N. Arellano
ANDREW N. ARELLANO
DPO IN-CHARGE

APPROVED BY:

Cynthia M. Tumanut
CYNTHIA M. TUMANUT
AREA/AIRPORT MANAGER, CAA/P AREA V

PROJECT:

REPAIR & REPAINTING OF RUNWAY, TAXIWAY AND APRON MARKING AND MARKERS

LOCATION:

BICOL INTERNATIONAL AIRPORT
DARAGA, ALBAY

CONTENT:

DETAIL OF MARKINGS

SHEET NO.:

04
06



REPUBLIC OF THE PHILIPPINES
CIVIL AVIATION AUTHORITY OF THE PHILIPPINES

THIS DRAWING IS EXCLUSIVE PROPERTIES OF CIVIL AVIATION AUTHORITY OF THE PHILIPPINES AND MUST NOT BE REPRODUCED, EXHIBITED, LOANED NOR COPIED IN PART OR IN WHOLE WITHOUT PROPER PERMISSION AND/OR WRITTEN CONSENT FROM THE DIRECTOR GENERAL CAA.

AERODROME DEVELOPMENT AND MANAGEMENT SERVICE
AREA-V, LEGAZPI AIRPORT

ENGINEERING & PLANNING UNIT

PREPARED BY:

[Signature]
LIMUEL MARI T. MALLORCA
AIRPORT TECHNICAL ASSISTANT

CHECKED BY:

[Signature]
MARC ANTHONY D. SABALDICA
AERODROME ENGINEER

APPROVAL RECOMMENDED BY:

[Signature]
ANDREW N. ARRIOLANO
EPU IN-CHARGE

APPROVED BY:

[Signature]
CYNTHIA M. LUMANIT
AREA/AIRPORT MANAGER, CAAP AREA V

PROJECT:

REPAIR & REPAINTING OF RUNWAY, TAXIWAY AND APRON MARKING AND MARKERS

LOCATION:

BICOL INTERNATIONAL AIRPORT
DARAGA, ALBAY

CONTENT:

• DETAIL OF MARKERS

SHEET NO.:

05
06

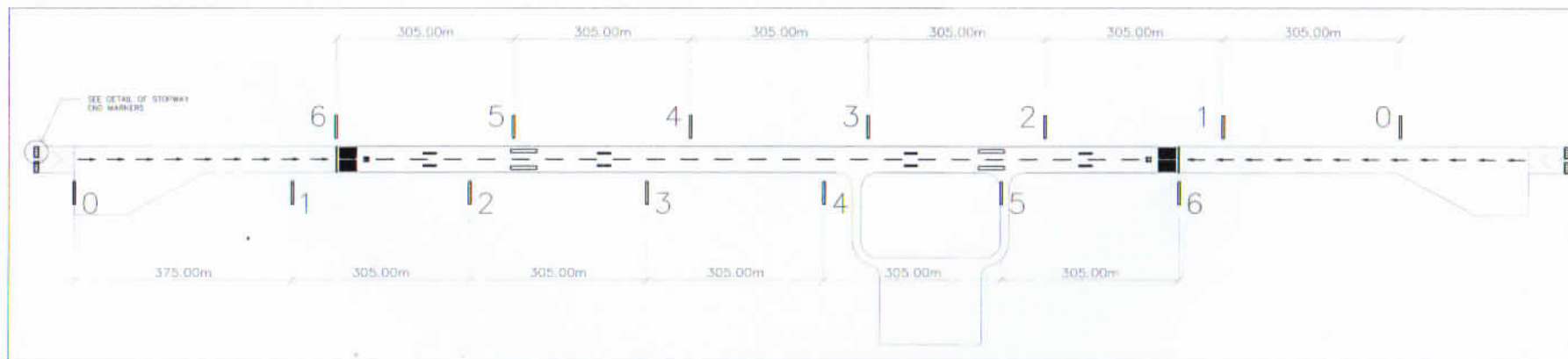

LOCATION OF DISTANCE TO-GO MARKERS
SCALE: NTS.

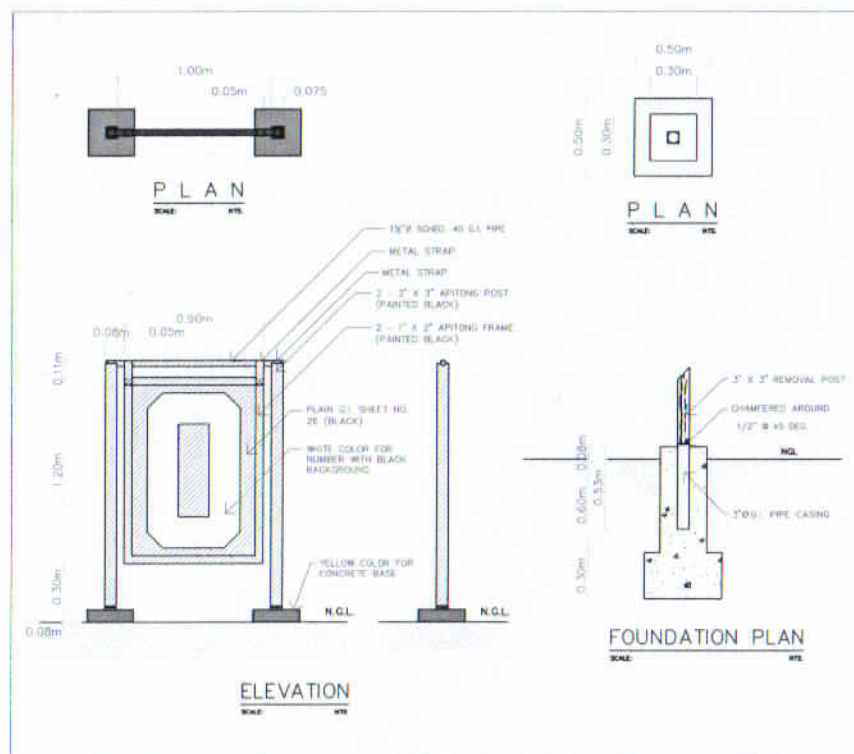

DETAIL OF DISTANCE TO-GO MARKERS
SCALE: NTS.

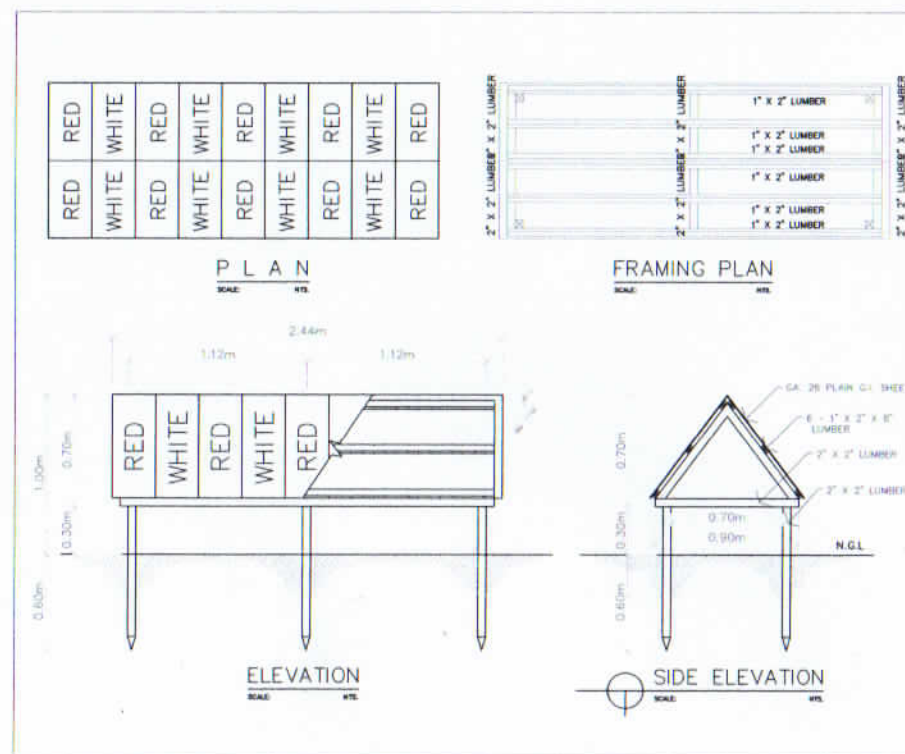

DETAIL OF STOPWAY END MARKERS
SCALE: NTS.



REPUBLIC OF THE PHILIPPINES
CIVIL AVIATION AUTHORITY OF THE PHILIPPINES

THIS DRAWING IS EXCLUSIVE PROPERTIES OF CIVIL AVIATION AUTHORITY OF THE PHILIPPINES AND MUST NOT BE REPRODUCED, EXHIBITED, LOANED, NOR COPIED IN PART OR IN WHOLE WITHOUT PRIOR PERMISSION AND/OR WRITTEN CONSENT FROM THE DIRECTOR GENERAL CAAP.

AERODROME DEVELOPMENT AND MANAGEMENT SERVICE
AREA-V, LEGAZPI AIRPORT

ENGINEERING & PLANNING UNIT

PREPARED BY:

LIMUEL MARI T. MALLORCA
AIRPORT TECHNICAL ASSISTANT

CHECKED BY:

MARC ANTHONY D. SABALDICA
AERODROME ENGINEER

APPROVAL RECOMMENDED BY:

ANDREW N. ARCECANO
SP-III IN-CHARGE

APPROVED BY:

CYNTHIA M. TUMANLUT
AREA/AIRPORT MANAGER,
CAAP AREA V

PROJECT:

REPAIR & REPAINTING OF
RUNWAY, TAXIWAY AND
APRON MARKING
AND MARKERS

LOCATION:

BICOL INTERNATIONAL AIRPORT
DARAGA, ALBAY

CONTENT:

• DETAIL OF NUMBERS
FOR DISTANCE TO-GO
MARKERS

SHEET NO.:

06
06

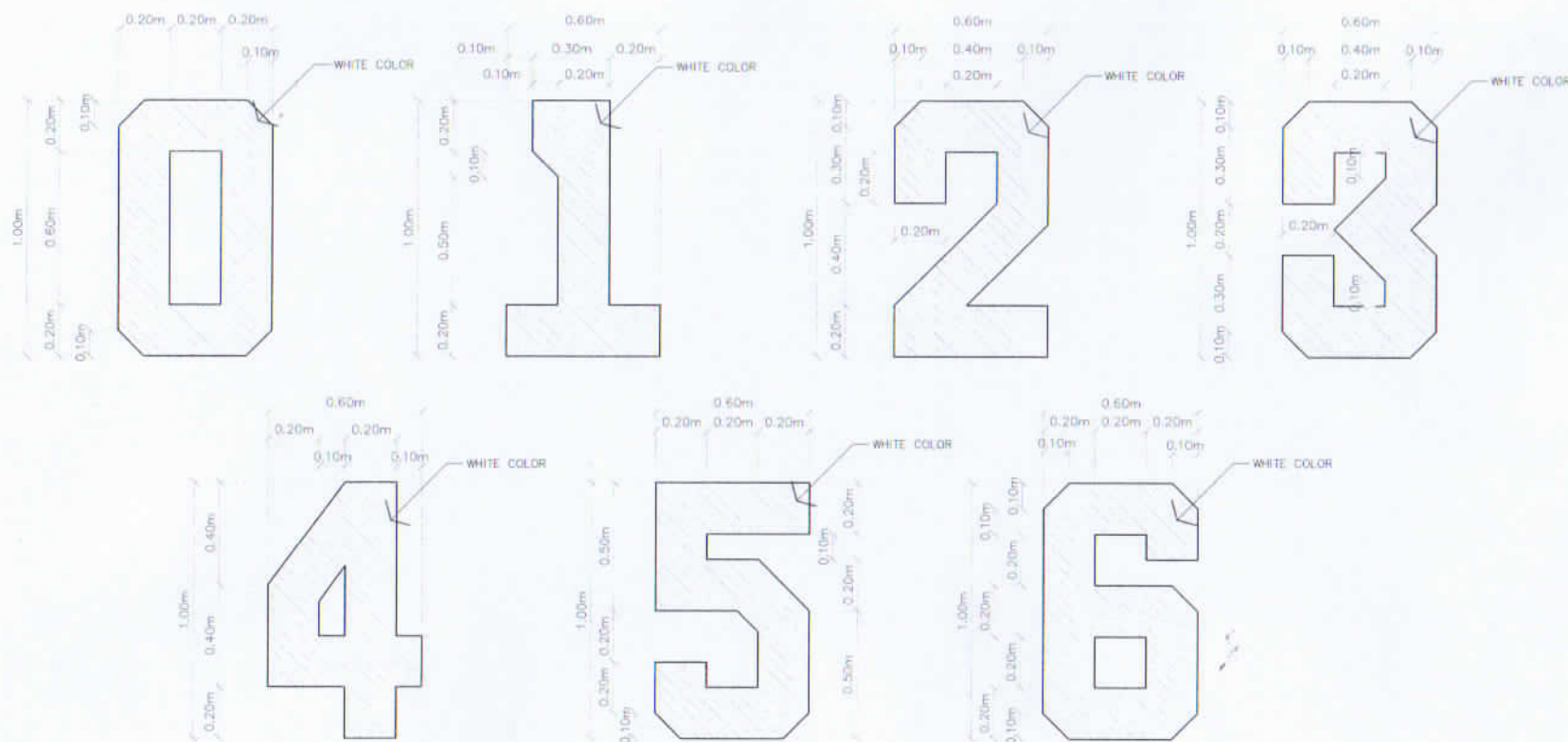

DETAIL OF NUMBERS FOR "DISTANCE TO-GO MARKERS"

SCALE:

NTS.